

## **Grand Opening Celebration**

for the new

### **Venice - Abbot Kinney Memorial Branch Library**

501 S. Venice Blvd.

**Saturday, August 12, 1995**

**10:00 a.m.**

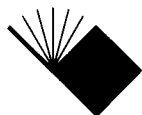

**LOS ANGELES  
PUBLIC LIBRARY**

## **History of the Venice - Abbot Kinney Memorial Branch Library**

The Venice - Abbot Kinney Memorial Branch joined the Los Angeles Public Library (LAPL) system in 1926 when the community was annexed to the City of Los Angeles. The branch was originally known as the Venice Library and in 1991 its name was changed to honor Abbot Kinney, the founder of Venice.

The library first occupied a modest building at 1110 Washington Blvd., then in 1930, a new facility was constructed at 610 California Ave. Eventually the library outgrew this facility and the building no longer met earthquake codes.

In the 1970s, LAPL and the community began exploring options for enlarging the branch library. Because the building could not be expanded to provide adequate space for library materials, community meetings, and important services such as literacy instruction and after-school tutoring, it was decided to construct a new facility on city-owned land located between North and South Venice boulevards and Ocean Avenue. Construction began on July 9, 1993.

The new 10,500-square-foot building, designed by Ernest P. Howard & Associates, doubles the space of the previous structure and can accommodate 40,000 books. Among its features are a collection of popular books, magazines and videos for people of all ages, an on-line public access catalog which enables patrons to access the full resources of the Los Angeles Public Library, and 14 computers, several of which will provide access to the Internet. A multipurpose room is designed so that it may be used when the library is closed.

The new building also reflects the eclectic character of Venice. The dramatic one-story structure is crowned with timber supports and glass to make optimum use of natural light. The entry, exhibition space and check-out and reference desks occupy a forty-foot-high central hall that extends the length of the building and leads directly to an octagonal room housing the book stacks. On either side of this grand hall are the children's reading room and the adult reading room. Artist Betty Dore designed the public art component of the new facility; a series of murals depicting historical and contemporary Venice as well as the wonders in the library.

The new facility was funded through a federal Housing and Community Development Block Grant and the 1989 Branch Library Facilities Bond.

The former library building on California Avenue has been seismically reinforced and with the help of Sixth District Councilwoman Ruth Galanter, in whose district the building is located, plans are underway to adapt it for other community uses.

With its new facility, the Venice - Abbot Kinney Memorial Branch Library can better serve the people of Venice as an informational, cultural and community resource, and provides a distinctive image suitable to its prominent gateway location.

## **Historia de la Biblioteca Sucursal de Venice - Memorial de Abbot Kinney**

La Biblioteca Sucursal de Venice - Memorial de Abbot Kinney se incorporó al Sistema de la Biblioteca Pública de Los Angeles (LAPL), en 1926, cuando la comunidad se anexó a la Ciudad de Los Angeles. La sucursal se conoció originalmente como la Biblioteca de Venice y en 1991 su nombre fue cambiado para honrar Abbot Kinney, el fundador de Venice.

La biblioteca primero ocupó un edificio modesto en 1110 Washington Blvd., y después en 1930 un nuevo edificio fue construido en 610 California Ave. Con el tiempo la biblioteca fue creciendo y este edificio ya no fue adecuado. Además, no era seguro en casa de terremoto.

Por los 1970, la Biblioteca Pública de Los Angeles y la comunidad comenzaron a explorar opciones para agrandar la biblioteca sucursal. Porque el edificio no podía ser agrandado para proveer espacio adecuado para materiales bibliotecarios, reuniones comunitarias y servicios importantes como instrucción en alfabetismo y tutela después de horas escolares, se decidió construir un nuevo edificio en terreno de la ciudad, ubicada entre las Blvd. Venice Norte y Sur y Ocean Ave. La construcción comenzó el 9 de julio, 1993.

El nuevo edificio de 10,500 pies cuadrados, diseñado por Ernest P. Howard y Socios, dobla el espacio del edificio previo y puede alojar 40,000 libros. Se destacan una colección de libros populares, revistas y videos para gente de cualquier edad, un catálogo público en línea, el cual permite acceso a todos los recursos de la Biblioteca Pública de Los Angeles, y 14 computadoras, algunas de las cuales proveerán acceso a la red global de información (Internet). Un salón multi-funcional está diseñado para que se pueda usar cuando la biblioteca esté cerrada.

A través del nuevo edificio también se refleja el carácter ecléctico de Venice. La estructura dramática de un piso se corona con soportes de madera y vidrio para hacer uso óptimo de la luz natural. La entrada, espacio para exhibiciones y mostradores de consulta y préstamos ocupan un pasillo central de cuarenta pies de alto que se extiende a un salón octagonal alojando los estantes para libros. A uno u otro lado de este gran pasillo están los salones para lectura juvenil y de adultos. La artista Betty Dore diseñó el componente de arte pública del nuevo edificio; una serie de murales representando la Venice histórica y contemporánea, así como también las maravillas de la biblioteca.

El nuevo edificio es realidad gracias a una Donación para Desarrollo Comunitario y de Vivienda del gobierno federal y al Bono para Servicios Públicos de Bibliotecas Sucursales de 1989.

El edificio anterior ubicado en California Ave. ha sido reforzado sísmicamente con la ayuda de la Concejal del Sexto Distrito, Ruth Galanter, en cuyo distrito se ubica el edificio. Hay planes en camino para adaptarlo a otros usos comunitarios.

Con este nuevo edificio, la Biblioteca Sucursal de Venice - Memorial de Abbot Kinney puede servir mejor a la gente de Venice como un recurso de información cultural y comunitaria. También así puede proveer una imagen distintiva apropiada a su posición prominente como medio de acceso.

# **VENICE - ABBOT KINNEY MEMORIAL BRANCH LIBRARY**

## **PUBLIC ART MURAL**

The public art component of the new Venice Abbott Kinney Memorial Branch Library facility is a three-part mural designed and painted by artist Betty Dore. The soon-to-be-completed mural celebrates the library as an endless source of enrichment, embraces the surrounding community, and enhances the building's dramatic interior.

The mural's first section, located in the Children's Reading Room, features paintings of birds combined with poetry written in many languages. The birds represent spiritual and intellectual freedom in many cultures and the poetry exemplifies the power and complexity of language.

The second section, in the Adult Reading Room, depicts archeological fragments from past and present cultures. These are combined with words, symbols and letters to illustrate the contributions from all previous peoples to our modern world. Symbols of science, mathematics and astronomy represent important contemporary additions to modern life.

The third section of the mural, located adjacent to the Circulation Desk, symbolizes the connection between Venice, Italy, and Venice, California. The "V" figure emphasizes the connections between the past, present and future, as well as the charm that Venice, California, founder Abbott Kinney sought to transport to his community. The letter "C" represents Venice, California, and includes cultural representations of the diverse communities found in the city. Both letters are rendered in gothic script to symbolize the first European writings and the libraries of the past.

## **ARTIST BETTY DORE**

Betty Dore has designed and painted murals in locations throughout the Los Angeles area, including the Huntington Library in San Marino, Pasadena City Hall, Afflerbaugh-Paige High School in La Verne, and the Peace Center in Los Angeles. Her work has been featured in solo exhibitions in Los Angeles, Pasadena and Beverly Hills. She also has been exhibited in group shows including the Arroyo Arts Collective Annual Juried Competition, Los Angeles Contemporary Exhibitions (LACE), the New World Center in Hong Kong, and the Laguna Breach Museum of Art. Among the awards Betty Dore has received for her art are the Purchase Award from the Mid-America Art Exhibit, and the Gottlieb Foundation Award.



**LOS ANGELES PUBLIC LIBRARY**

## Program

MISTRESS OF CEREMONIES

**Linda Alvarez**, Anchor/Reporter, KCBS Channel 2

PRESENTATION OF COLORS

**West Los Angeles Explorer Scouts**

INVOCATION

**Sr. Anna Mary Meyer, C.S.J.**, Director of Pastoral Care,  
Daniel Freeman Marina Hospital

WELCOME

**Susan Goldberg Kent**, City Librarian

SPEAKERS

**Richard J. Riordan**, Mayor of Los Angeles  
**Ruth Galanter**, Councilmember, Sixth District  
**Debra Bowen**, Assemblywoman, Fifty-Third District  
**Olivia Cueva-Fernández**, President, Board of Library Commissioners  
**J. P. Ellman**, President, Board of Public Works  
**Parker C. Anderson**, General Manager, City of Los Angeles  
Community Development Department  
**Maxine Leral**, President, Friends of the Venice Branch Library  
**Orson Bean**, actor and author  
**Susan Getlein**, student, Westminster Elementary School

LIBRARY CHEER

**Westside Pop Warner Football Cheerleaders**

OPENING FANFARE

**Paul Francis Witt**, composer  
**Richard Abcarian, Janet Henry & Paul Francis Witt**, trumpeters

RIBBON CUTTING CEREMONY

ENTERTAINMENT

**Venice Youth Pops Orchestra Jazz Ensemble & Guests**  
**Delbert Taylor**, Conductor

REFRESHMENTS

**Friends of the Venice Branch Library**

Thanks to the following for their support of today's festivities: Aunt Kizzy's Back Porch, Carousel, Classic Party Rentals, Doubletree Inn, Gelson's Markets, Maddock's & Company, Ralph's Grocery Company, Smart & Final Inc., Venice Farmer's Market, K+K Delivery Co.

## Schedule of Events

### Entertainment

- 11:00 a.m. - 12:30 p.m. **Music** - Vince Morton & Co. Quintet
- 12 noon - 2:00 p.m. **Readings** - children's authors John Gardiner, Kathryn Hewitt, Robin Rector Krupp and Ann Whitfield Paul will read and sign copies of their books. Books available for purchase through Catch Our Rainbow, courtesy of the Friends of the Venice Branch Library. (Children's Picture Book Area)
- 12:45 p.m. - 1:45 p.m. **Recital** - singer Harlene Stein
- 2:00 p.m. - 3:00 p.m. **Theater Performance** - Santa Monica Playhouse presents theater magic and entertainment for all ages. (Multi-purpose Room)
- 2:00 p.m. - 3:00 p.m. **Children's Storytelling** - Grandparents and Books presents a reading by Lorraine Simpson. (Children's Picture Book Area)
- 3:00 p.m. - 4:00 p.m. **Children's Storytelling** - Grandparents and Books presents a reading by Rosalee Dunphy. (Children's Picture Book Area)
- 3:00 p.m. - 4:00 p.m. **Poetry Reading** - Beyond Baroque Literary Arts Center presents Venice poets Philomene Long and John Thomas. (Multi-Purpose Room)
- 4:00 p.m. - 5:00 p.m. **"Fish Hooky"** - the Venice Historical Society presents this classic 1933 "Little Rascals" movie filmed in Venice. (Multi-Purpose Room)

### Exhibitions

**"Venice, California, 1964 - 1994: The Photographers' View,"**  
an exhibit of photographs depicting the history of Venice.  
Curated by Maryjane Lang.

**"North Beach 90291,"** Rich Mann's 60-exposure photo compilation is a permanent gift to the library.

**"Bookmark Paintings,"** original art by Gene Maslow.

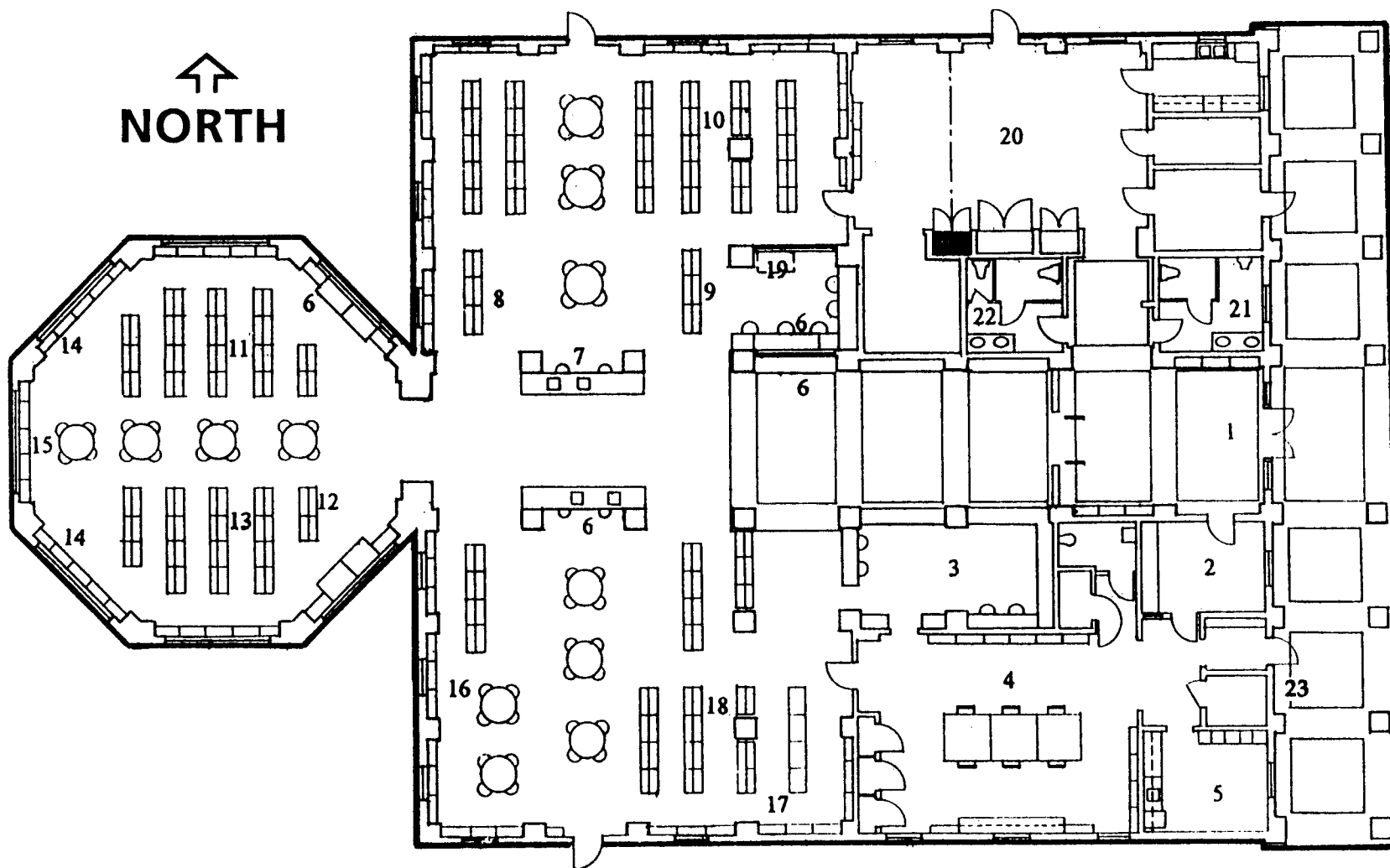
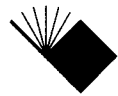

1. Main Entrance / Entrada Principal
2. Senior Librarian's Office / Oficina de la Directora
3. Circulation Desk / Mostrador de Préstamos
4. Staff Workroom / Oficina del Personal
5. Staff Lounge / Comedor del Personal
6. On-line Catalog / Catálogo en Línea
7. Information Desk / Mostrador de Información
8. Reference Books / Libros de Consulta
9. Venice History Collection / Colección de Historia de Venice
10. Adult Non-Fiction / No-Ficción para Adultos
11. Spanish Books / Libros en Español
12. New Books / Libros Nuevos

13. Adult Fiction / Ficción para Adultos
14. Magazines / Revistas
15. Young Adult Area / Area para Jóvenes
16. Pre-School/Picture Books / Libros Preescolares/Ilustrados
17. Juvenile Fiction / Ficción Juvenil
18. Juvenile Non-Fiction / No-Ficción Juvenil
19. Copy Machine / Fotocopiadora
20. Multi-Purpose Room / Salón Multi-funcional
21. Men's Restroom / Servicios de Hombres
22. Women's Restroom / Servicios de Mujeres
23. Book Drop / Buzón de Libros

MAYOR OF LOS ANGELES

Richard J. Riordan

COUNCILWOMAN - SIXTH DISTRICT

Ruth Galanter

BOARD OF LIBRARY COMMISSIONERS

Olivia Cueva-Fernández, President

Lucy McCoy, Vice President

Linda Baldwin

Robert Burkett

Gary A. Ross

CITY LIBRARIAN

Susan Goldberg Kent

DIRECTOR OF BRANCHES

Carmen Martínez

ASSISTANT DIRECTOR OF BRANCHES

Fontayne Holmes

PRINCIPAL LIBRARIAN

BRANCH CONSTRUCTION PROJECTS

Juliana Cheng

WESTERN REGIONAL MANAGER

Kathryn Carr

BRANCH LIBRARIAN

Lucille Cappas

BRANCH STAFF

Shawna Saavedra, Children's Librarian; Kathy Scott, Young Adult Librarian;  
Addie Edwards, Rocio Hernandez, Clerk Typists; Maribel Garcia, Jesus Ramirez,  
Messenger Clerks.