

W. MAIN ST.

SPRING ST.

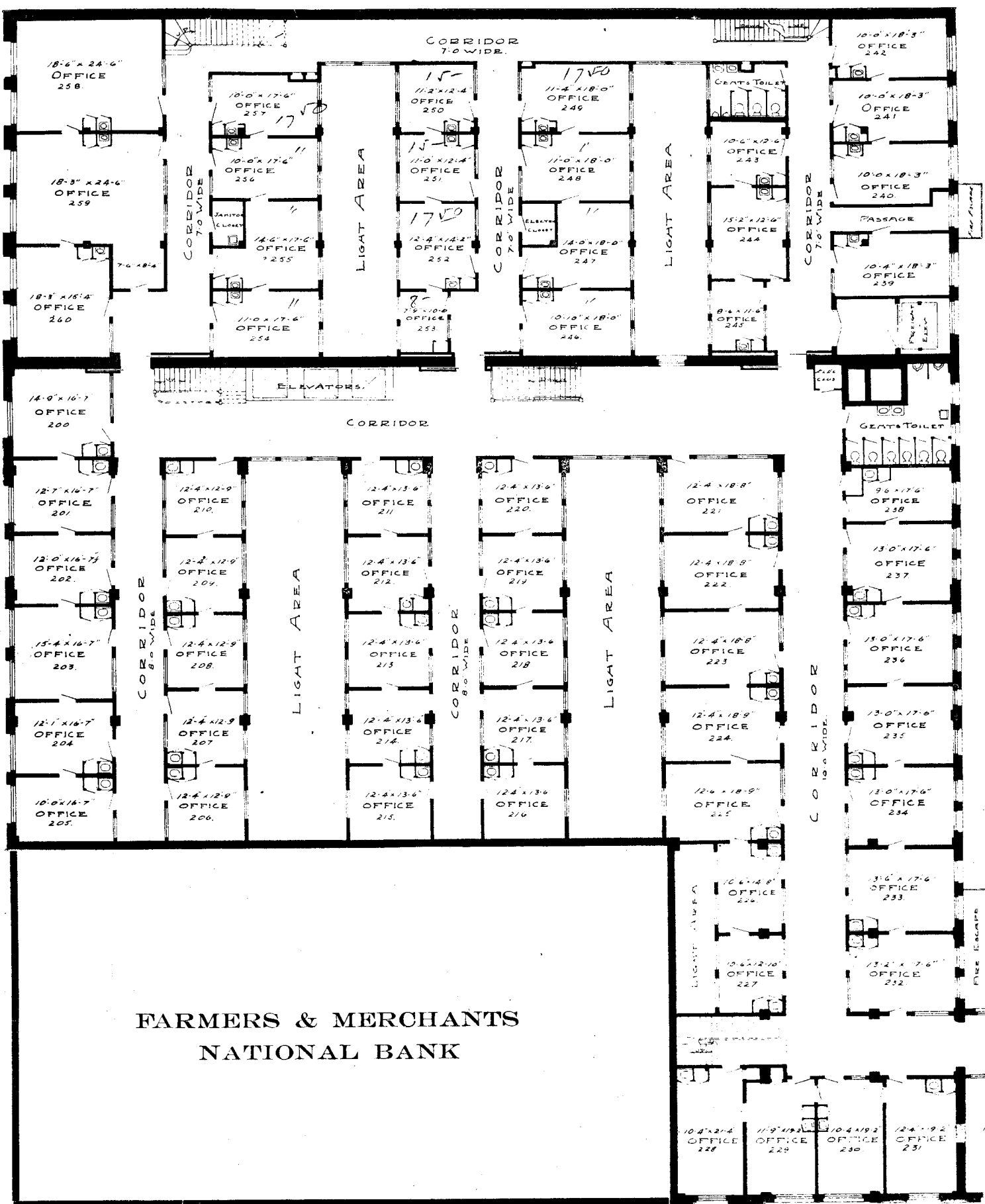

TYPICAL FLOOR PLAN
 ISAIAS W. HELLMAN BUILDING
 411 S. MAIN ST. 124 W. 4TH ST.
 LOS ANGELES, CAL.

MORGAN, WALLS & MORGAN, Architects

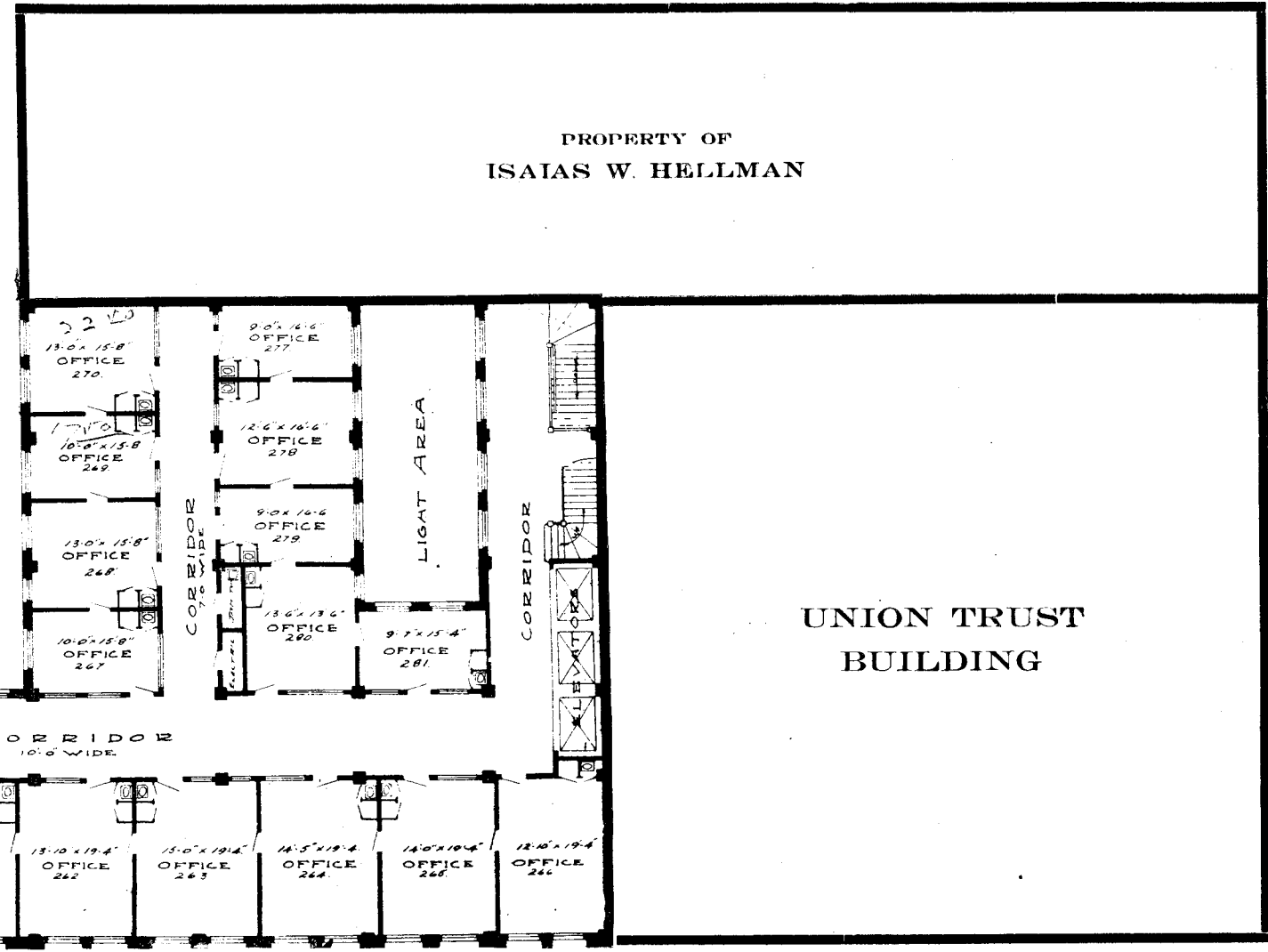

FARMERS & MERCHANTS
NATIONAL BANK

PROPERTY OF
ISAIAS W. HELLMAN

UNION TRUST
BUILDING